

Product Instructions **Single Sided Gridwall Kits**

Included:



• 1 x Gridwall Panel



• 2 x Legs



• Fixings



• 4 x Wall Mounting Brackets

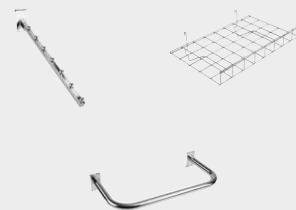

• Gridwall Components (dependant on kit purchased)

How to apply

1.

Screw the four feet into the threaded holes underneath the legs.



2.

Using the fixings provided; connect the legs to each side of the gridwall panel via the pre-drilled holes in the sides of the legs.



3.

With the main body of the display now assembled, adjust the projection of each of the feet by twisting them clockwise/anticlockwise as appropriate.



4.

To keep the gridwall in place, we recommend using the supplied wall mounting brackets. To do so; position the unit against the preferred wall space, hook each bracket from below the gridwall mesh and screw in place.

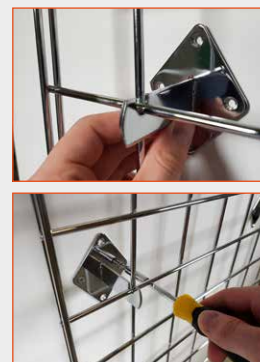

5.

Gridwall hooks and accessories can now be fitted to the display.

