

# FD97 ANGLED BROCHURE STAND

## PRODUCT INSTRUCTIONS

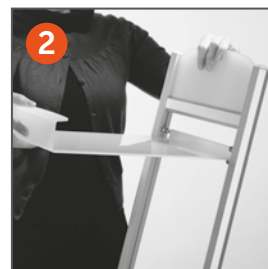

**1.** Screw and fasten the legs on the main body profile of the frame.



**2.** Put the shelf through main body profile.

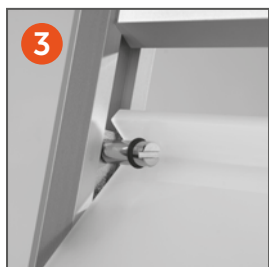

**3.** Fix the short twisted part of the shelf on the edge pins.

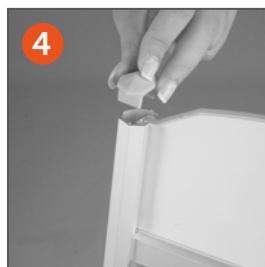

**4.** Take off the end-caps from header part. Slide out two pieces of header from profile channels.



**5.** Place your logo between 2 pieces of header. Slide-in the header part from profile channels.

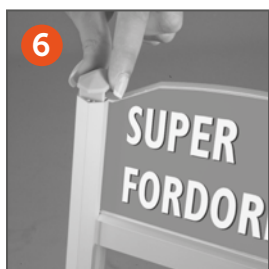

**6.** Place the end-caps on the header.

