

Assembly Instructions: Flat-Pack Acrylic Display Pedestal

Components

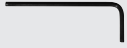

1x Allen key



12x fixings



24x screws

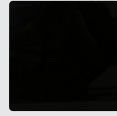

1x top panel

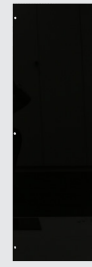

2x side panels
(0.7cm hole distance)

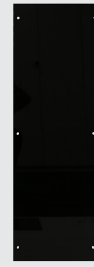

2x side panels
(1.3cm hole distance)

Please note

There are two pairs of side panels which have differing distances from the edge of the panels to the holes. The matching pairs must face opposite sides of the plinth in order to be constructed correctly.

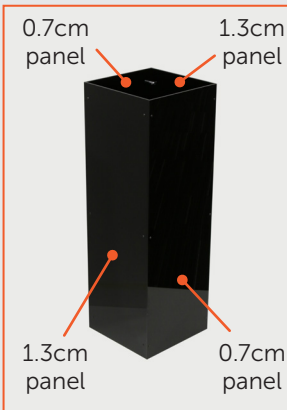
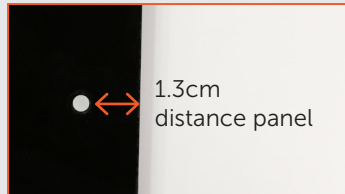
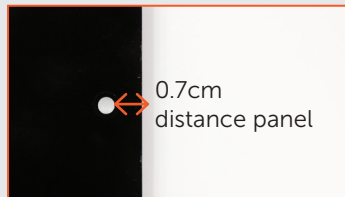

Fixings and screws attach to each panel according to the below diagram.

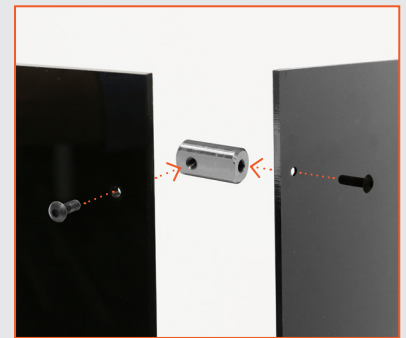

1. Remove protective film from both sides of the top and side panels. We advise that you construct this with two people for ease, and to minimise the potential for surface scratches.



2. Using a 0.7cm panel, thread and screw a fixing onto the panel horizontally. Then, using a 1.3cm panel, thread and screw the panel onto the remaining side of the fixing.



3. Repeat this process for the remaining holes, fixings and panels.

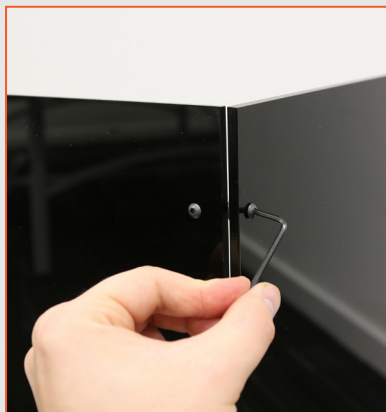

4. Place the top panel onto the top of the unit, ensuring the raised corners are facing downwards so the top locks into place to complete the unit.

